

Uglee Bin Lid Cable Installation Guide

Tools.

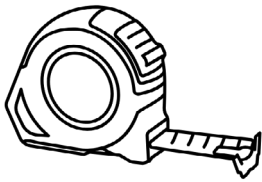

Tape Measure

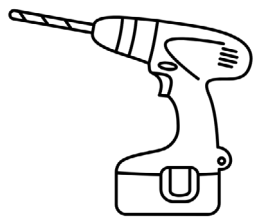

Cordless Drill

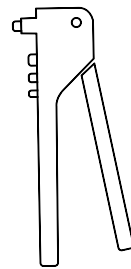

Rivet Gun



Crimping
Pliers

Bin Cable Parts.



Bin Cable
& Carabiner



C Bracket



Rivets

Uglee™

See other side



Cable Installation

Step 1 - Fitting the C bracket & finding cable length.

Firstly, figure out where on the inside of the roof panel you wish to attach the bracket. For this system to work best we recommend placing the bracket somewhere near the centre of the roof.

Once you have figured out the placement, measure and mark two points the same distance apart as the two mounting holes on the bracket.

Pre-drill holes on these marks then put the bracket in place lining up the holes and rivet the bracket to the inside of the roof panel.

To find the cable length, lift your bin lid to the height you wish. Measure the distance from the bracket to the bin lid handle.

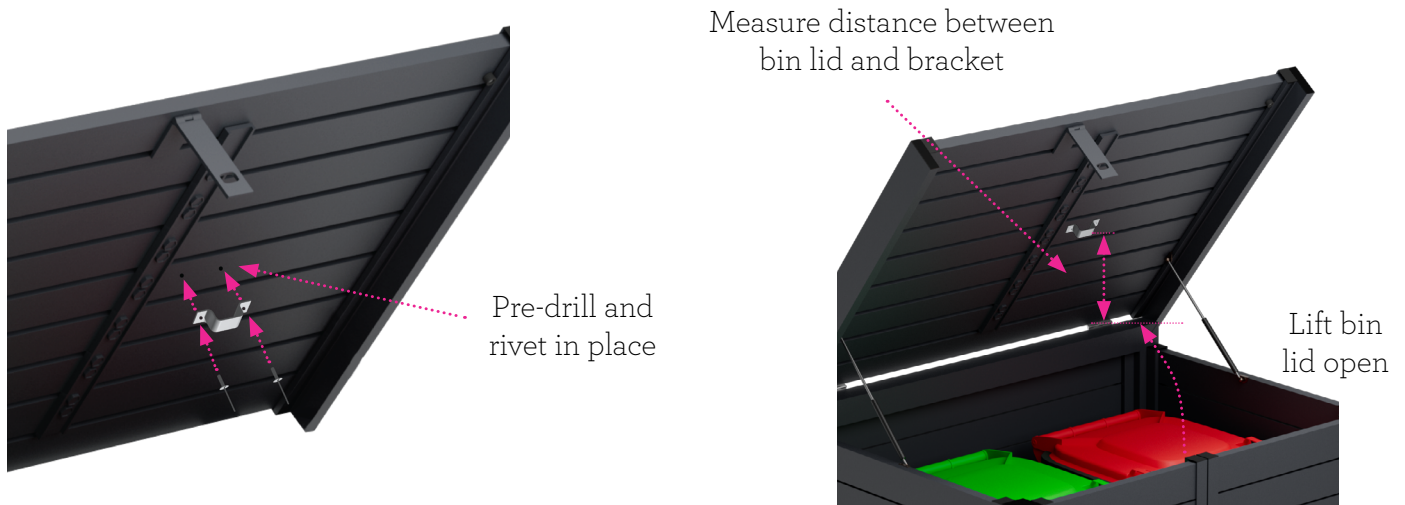

Step 2 - Attaching cable.

Using the measurement you found above, Loop the un-crimped end of the cable through the bracket and adjust the cable length to your measurement. Feed the cable back through the crimp and use crimping pliers to lock in place.

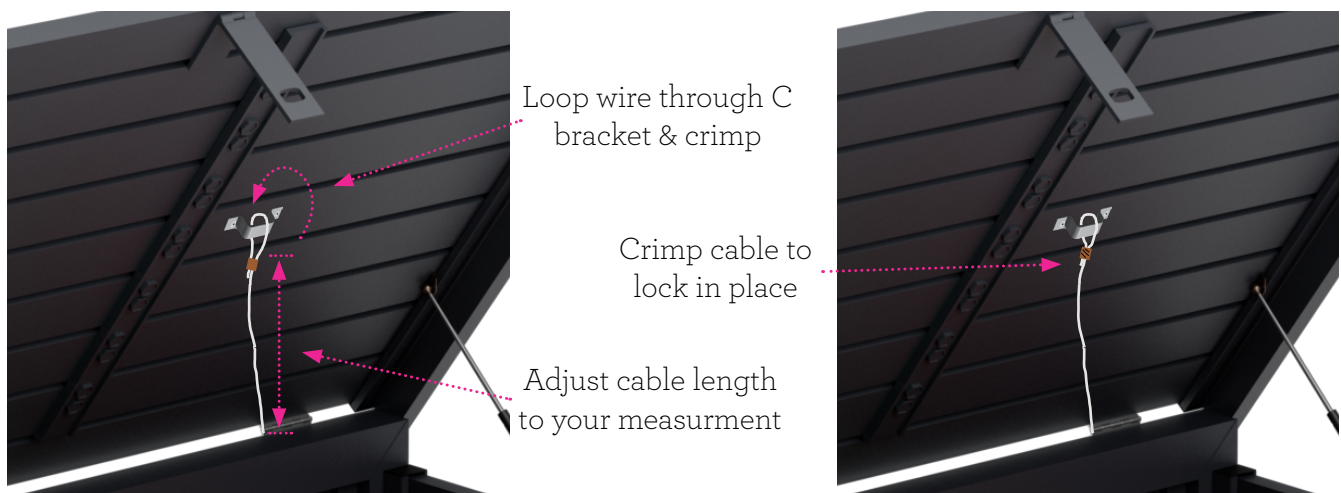

Attach the carabiner end to your bin lid handle and you're all set, when you open your Uglee lid your bin lids will follow!