



Solid Panel Fencing



Scan to view all
BelAire fence drawings

BelAire[®]
DESIGNER FENCING

...make it your own!



Solid Acoustic Panel Fencing

In today's world, noise reduction is one of the leading concerns across New Zealand home owners. The BelAire range of acoustic fences and noise barriers have been specifically engineered to meet the acoustic demands of our modern world.

We handle a variety of noise reduction concerns; from general neighbourhood noise, to road noise, to high-performance noise absorption enclosures for pool pumps and HVAC units. On average, our acoustic fences and road noise barriers typically achieve a 20-30dB reduction (depending on noise source and noise type), which equates to a quartering of loudness.

Understanding 'loudness', or the human perception of sound, can be tricky; but you can test just how much difference this makes with the simple help of a video and its volume controls. First, watch the video at 100% volume. Then, reduce the volume to 25%; this is the potential noise reduction that our acoustic fences offer.

Put the controls back into your hands; turn down the volume of loud neighbours and traffic noise today.

ACOUSTIC FENCING

BelAire solid wall systems are acoustically tested and rated, keeping all unwanted surrounding noises at bay and providing peace and quiet for your home.

ECO FRIENDLY

Our innovative products are made of recyclable materials, with our manufacturing processes reducing emitted and embodied CO₂ by up to 80%.

NZ MADE

All BelAire walls products are NZ designed and manufactured to strict international quality standards.

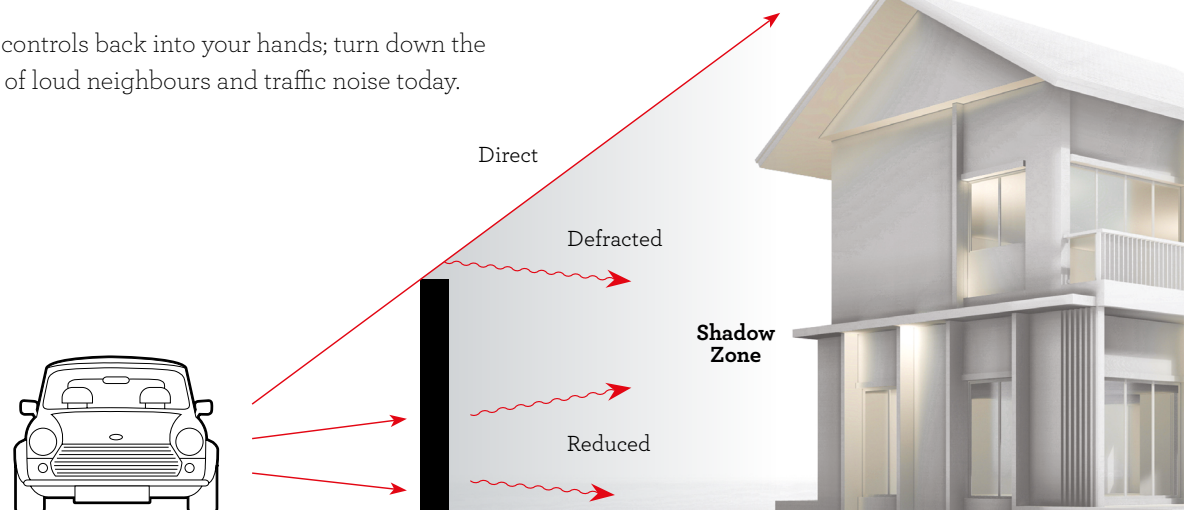



BelAire®
DESIGNER FENCING

...make it your own!

Solid Panel Fencing

MODULAR SYSTEM

BelAire solid panel fencing is the most advanced modular fencing system available in New Zealand today.

DESIGNED BY YOU

With the Classic, Signature and Estate styles to choose from, you can design your fence to suit your lifestyle. Our fences and posts are all fully paintable so that you can complement or match the colour of your property.

You can also add stylish slat, louvre, tubular or glass infills, plus there is a choice of flush or exposed capping for posts and panels – the options for your fence are only limited by your imagination.

COST-EFFECTIVE

BelAire solid panel fencing has all the properties of a block wall at a fraction of the cost and mess!

BUILT TO LAST

Our pre-primed, galvanized, high-tensile support posts are very light yet structurally very strong. Our EPS/fibre cement panels are designed to withstand the typical demands placed on a fence in any environment.

EASY (DIY) INSTALLATION

Our fences are designed to be assembled with ease. There is no need for heavy construction and digging

equipment, or cranes – BelAire panels can be easily handled by two people. They are easy to install in difficult-to-access areas such as back yards or annexed ground.

We provide step by step self-install instructions that any competent DIY person should be able to follow, but if you'd rather get someone else to install it, we have a list of preferred installers throughout NZ. Call us on 0800 235 2473 and we will put you in touch with an installer in your area.

WARRANTY

New Zealand-made with a 5-year warranty period. Be assured that with very little maintenance your fence will give you great privacy and security for many years to come. Only the finest raw materials have been used in the construction of your fence. The suppliers of these raw materials state that they have a design life well in excess of 20 years. With this assurance we offer you a replacement warranty for any component of your new fencing if it fails within 5 years* from date of purchase.



*2yr Warranty within a 1500m sea spray zone.

EXPOSED JOIN OR CLOSED JOIN?

An exposed join is recommended – it is more forgiving if you haven't quite got the panels 100% level, and also gives a much more attractive result.

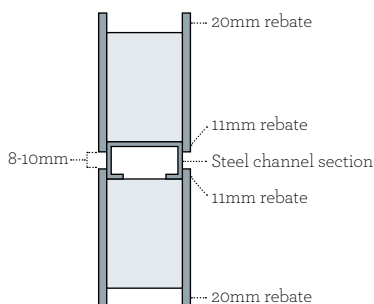

<< How to achieve a exposed join

Insert the steel channel section into the 11mm rebate in the panels

How to achieve a Closed join >>

Insert the steel channel section into the 20mm rebate in the bottom panel

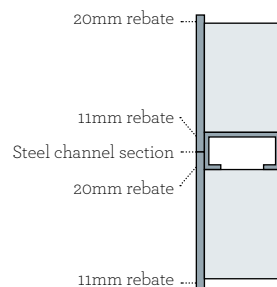

NOISE BARRIER

Our patented solid Poly-fibre cement composite sandwich panels are designed to reflect noise. The acoustic performance of this product was evaluated by the Acoustics Research Group at the University of Canterbury and a comprehensive report is available on request.

TYPICAL TRAFFIC NOISE – 12m from road edge

approx. 60 dBa: 2-lane urban road, 6,000 vehicles per day @ 50kph
approx. 68 dBa: 4-lane motorway, 25,000 vehicles per day @ 100kph

TYPICAL OTHER NOISE

approx. 90 dBa: Lawnmower
approx. 100 dBa: Circular saw

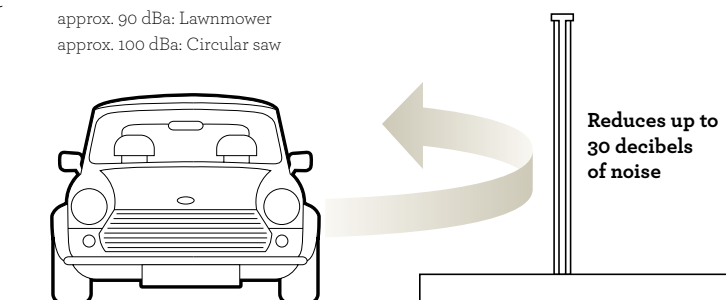

THE ALL-TERRAIN FENCE

BelAire solid panels can be easily cut using a circular saw with a timber blade. This will allow you to easily and neatly follow the terrain of your property.



CLASSIC

Post dimensions: 120mm (deep) x 180mm (face) 0.95 mm BMT

Panel thickness: 50mm

Density of composite panel materials: 15.49kg/m²

Suitable for fence heights: 900mm - 2400mm

Post centres: 2530mm, 2830mm

The classic fence is the most cost effective of the styles and most commonly used in residential boundary/screening fence applications. Suitable for less challenging terrain, this style of fence will provide great sound reduction qualities. Also suited to lower fence designs - 1200mm and 1500mm high.



SIGNATURE

Post dimensions: 140mm (deep) x 280mm (face) 0.95 mm BMT

Panel thickness: 70mm

Density of composite panel materials: 15.49kg/m²

Suitable for fence heights: 900mm - 3000mm

Post centres: 2630mm, 2930mm

The Signature fence, our most popular line, is most commonly used where a true masonry wall look is desired, or in a commercial and residential security/sound fence application. The fence has superb sound reduction qualities (National Acoustic Laboratory tested).



ESTATE

Post dimensions: 210mm (deep) x 320mm (face) 0.95 mm BMT

Panel thickness: 70mm

Density of composite panel materials: 15.49kg/m²

Suitable for fence heights: 900mm - 3000mm

Post centres: 2670mm, 2970mm

The Estate fence is most commonly used where a 'Grand' masonry wall look is desired. The post face is equivalent to a brick and a half in width, and the fence has superb sound reduction qualities (National Acoustic Laboratory tested).



CLASSIC

SPECIFICATIONS

Centre to Centre Guide

Panel Length	Post Hole Centres
2400mm	> 2530mm
2700mm	> 2830mm

Post Hole Depth Guide Wind Regions A&B

Hole Depth Into Firm Earth Or Clay	Fence Height	Hole Depth Into Sand, Soft Clay Or Loose Earth
450mm	> 900mm	> 550mm
550mm	> 1200mm	> 650mm
600mm	> 1500mm	> 700mm
650mm	> 1800mm	> 800mm
700mm	> 2100mm	> 900mm
800mm	> 2400mm	> 1000mm

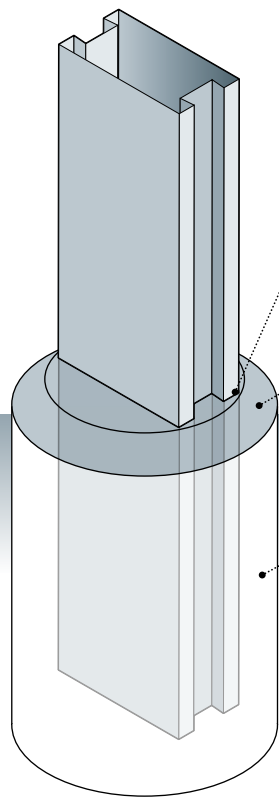
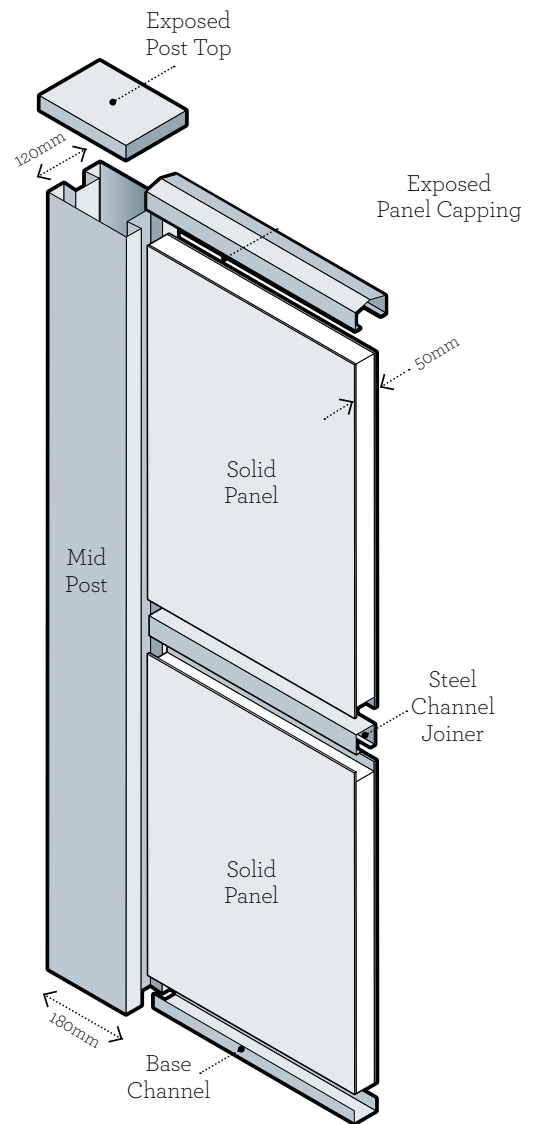
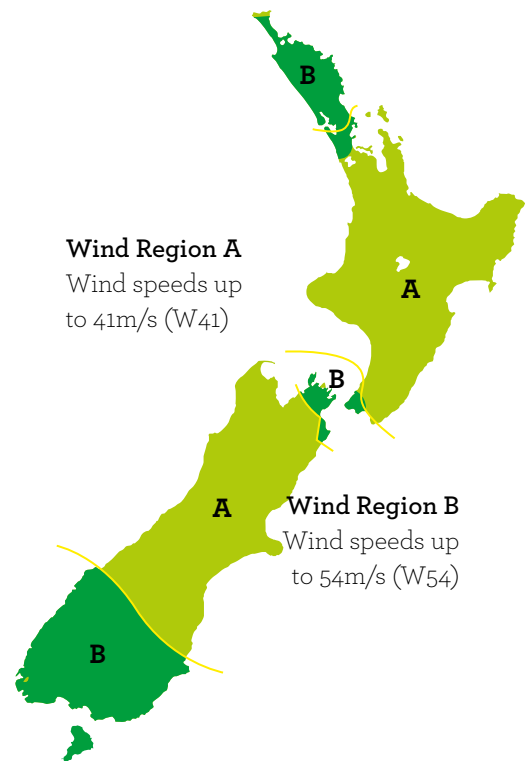

Post Hole Width:

280mm min (all wind regions)

Soil (including garden fill) should not be placed in contact with the steel post

Top of concrete should be sloped away from post for water drainage

Grade of concrete N20 with maximum size of aggregate 20mm. Concrete shall be compacted after placement inside footing hole.

CLASSIC

PRE-PRIMED STEEL COMPONENTS

Pillar

120mm (deep)
 × 180mm (face)
 × length subject to fence
 height plus post hole depth

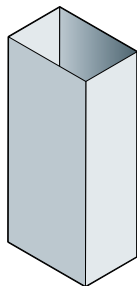

End Post

120mm (deep)
 × 180mm (face)
 × length subject to fence
 height plus post hole depth

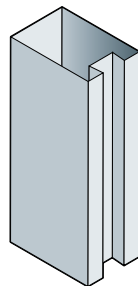

Mid Post

120mm (deep)
 × 180mm (face)
 × length subject to fence
 height plus post hole depth

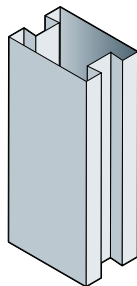

90° Post

120mm (deep)
 × 180mm (face)
 × length subject to fence
 height plus post hole depth

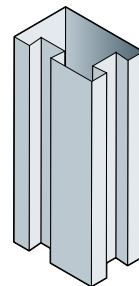

45°/Custom Angle Post

115mm (A) × 117mm (B)
 × 120mm (C)
 × length subject to fence
 height plus post hole depth

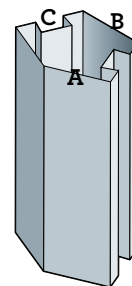

Post Infill

30mm (deep)
 × 50mm (face)
 × length subject to
 fence height

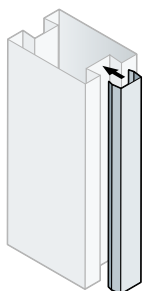

Wall Mount Channel & Masonry Anchor*

30mm (deep)
 × 52mm (back face)
 × length subject to
 fence height

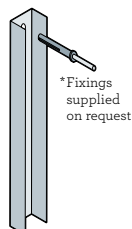

*Fixings
 supplied
 on request

Flush Post Top

120mm (deep)
 × 180mm (face)
 × 20mm (leg height)

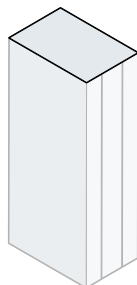

Exposed Post Top

170mm (deep)
 × 240mm (face)
 × 40mm (height)

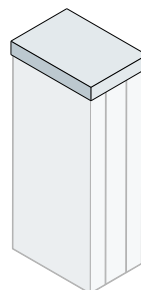

Flush 45° Post Top

110mm (A) × 115mm (B)
 × 118mm (C)
 × 20mm (leg height)

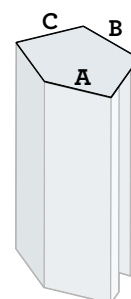

Exposed 45° Post Top

145mm (A) × 145mm (B)
 × 155mm (C)
 × 40mm (height)

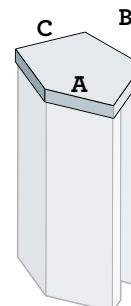

Flush Panel Capping

20mm (leg height)
 × 51mm (top face)
 × length subject to
 panel length

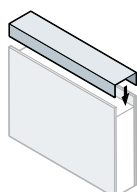

Exposed Panel Capping

45mm (leg height)
 × 80mm (top face)
 × length subject to
 panel length

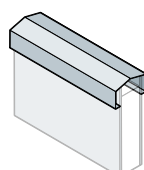

Base Channel

20mm (leg height)
 × 51mm (face)
 × length subject to
 panel length

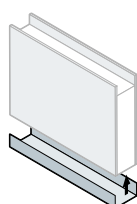

Steel Channel Joiner

30mm (deep) × 40mm (face)
 × length subject to
 panel length

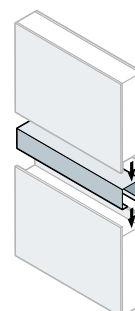

Tek Screw

10/16 galvanised
 tek screw
 16mm (length)



Support Bracket

35mm (deep)
 × 40mm (face with holes) ×
 48mm (wide)

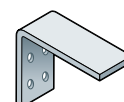

CLASSIC INFILL PANELS

Slat and **Aurora** are also available to enhance your fencing. Please refer to the individual infill pages later in this section.

SIGNATURE

SPECIFICATIONS

Centre to Centre Guide

Panel Length	Post Hole Centres
2400mm	> 2630mm
2700mm	> 2930mm

Post Hole Depth Guide Wind Regions A&B

Hole Depth Into Firm Earth Or Clay	Fence Height	Hole Depth Into Sand, Soft Clay Or Loose Earth
450mm	> 900mm	> 550mm
550mm	> 1200mm	> 650mm
600mm	> 1500mm	> 700mm
650mm	> 1800mm	> 800mm
700mm	> 2100mm	> 900mm
800mm	> 2400mm	> 1000mm
900mm	> 2700mm	> 1100mm
1000mm	> 3000mm	> 1200mm

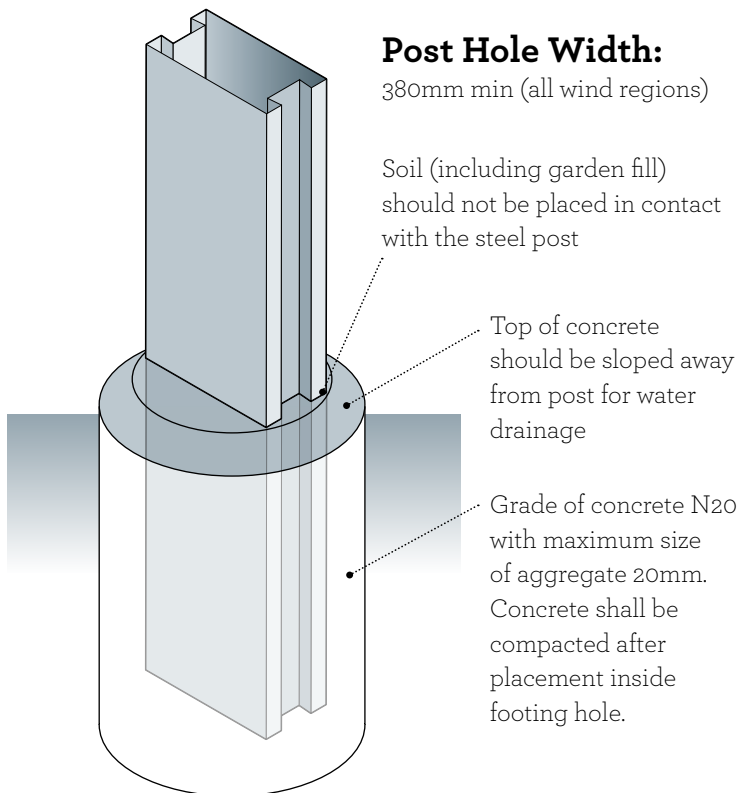
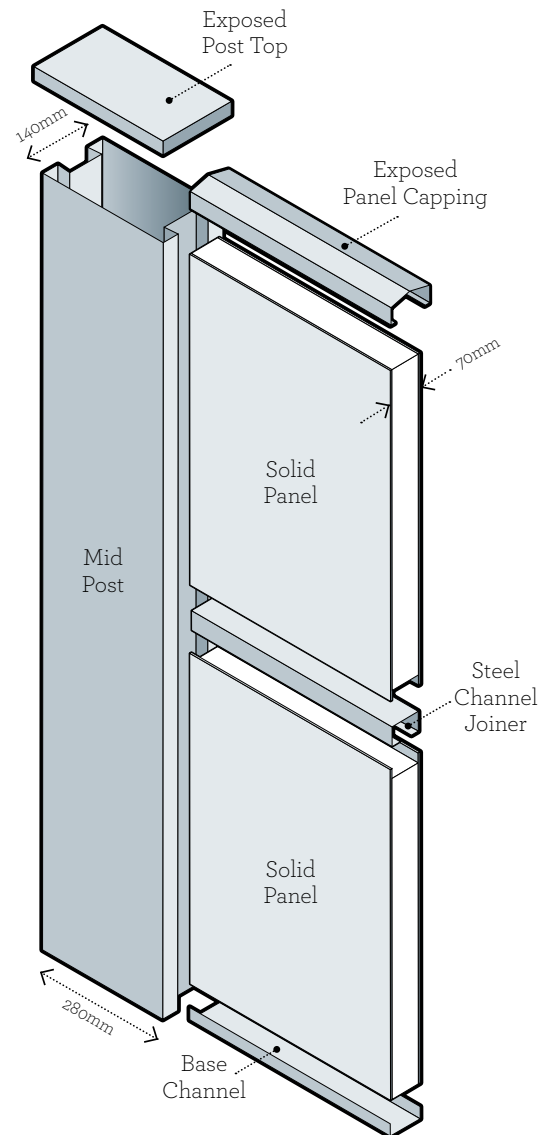
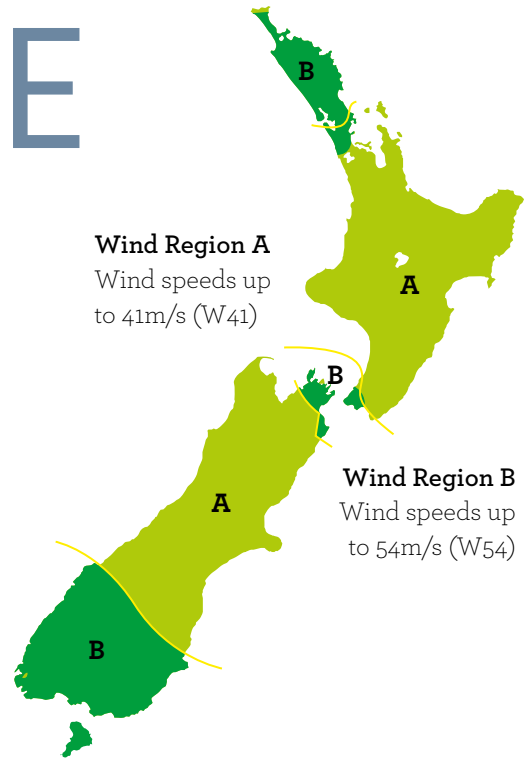

SIGNATURE

PRE-PRIMED STEEL COMPONENTS

Pillar

140mm (deep)
 X 280mm (face)
 X length subject to fence
 height plus post hole depth

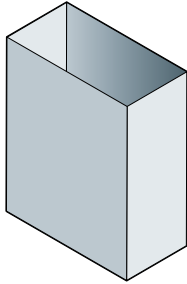

End Post

140mm (deep)
 X 280mm (face)
 X length subject to fence
 height plus post hole depth

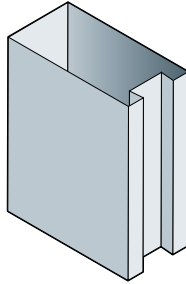

Mid Post

140mm (deep)
 X 280mm (face)
 X length subject to fence
 height plus post hole depth

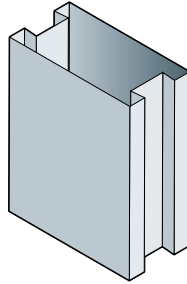

90° Post

140mm (deep)
 X 280mm (face)
 X length subject to fence
 height plus post hole depth

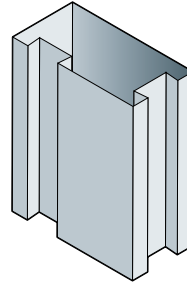

45°/Custom Angle Post

170mm (A) x 205mm (B)
 X 137mm (C)
 X length subject to fence
 height plus post hole depth

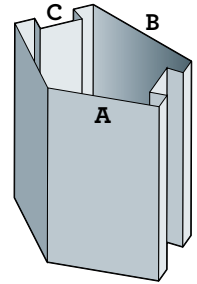

Post Infill

30mm (deep)
 X 70mm (face)
 X length subject to
 fence height

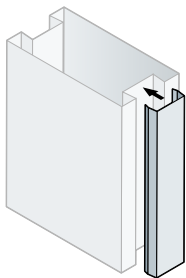

Wall Mount Channel & Masonry Anchor*

30mm (deep)
 X 72mm (back face)
 X length subject to
 fence height

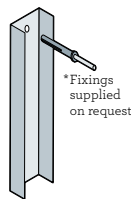

* Fixings
 supplied
 on request

Flush Post Top

140mm (deep)
 X 280mm (face)
 X 20mm (leg height)

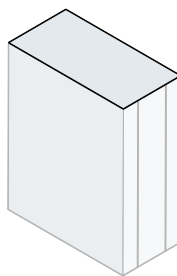

Exposed Post Top

190mm (deep)
 X 330mm (face)
 X 40mm (height)

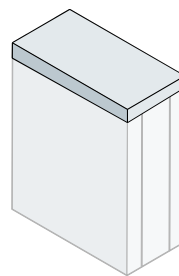

Flush 45° Post Top

165mm (A) X 199mm (B)
 X 139mm (C)
 X 20mm (leg height)

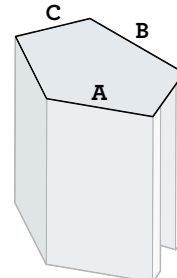

Exposed 45° Post Top

200mm (A) X 230mm (B)
 X 180mm (C)
 X 40mm (height)

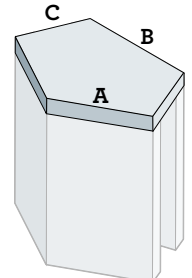

Flush Panel Capping

20mm (leg height)
 X 71mm (top face)
 X length subject to
 panel length

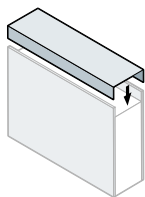

Exposed Panel Capping

55mm (leg height)
 X 100mm (top face)
 X length subject to
 panel length

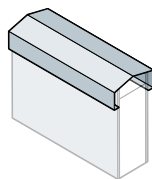

Base Channel

20mm (leg height)
 X 71mm (face)
 X length subject to
 panel length

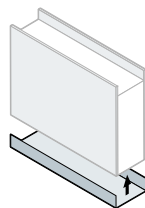

Steel Channel Joiner

30mm (deep) X 60mm (face)
 X length subject to
 panel length

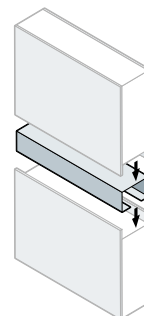

Tek Screw

10/16 galvanised
 tek screw
 16mm (length)

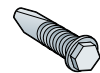

Support Bracket

40mm (deep)
 X 60mm (face with holes) X
 78mm (wide)

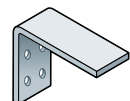

SIGNATURE INFILL PANELS

Slat, Louvre, Aurora and **Glass Infills** are also available to enhance your fencing. Please refer to the individual infill pages later in this section.

ESTATE

SPECIFICATIONS

Centre to Centre Guide

Panel Length	Post Hole Centres
2400mm	> 2670mm
2700mm	> 2970mm

Post Hole Depth Guide Wind Regions A&B

Hole Depth Into Firm Earth Or Clay	Fence Height	Hole Depth Into Sand, Soft Clay Or Loose Earth
450mm	> 900mm	> 550mm
550mm	> 1200mm	> 650mm
600mm	> 1500mm	> 700mm
650mm	> 1800mm	> 800mm
700mm	> 2100mm	> 900mm
800mm	> 2400mm	> 1000mm
900mm	> 2700mm	> 1100mm
1000mm	> 3000mm	> 1200mm

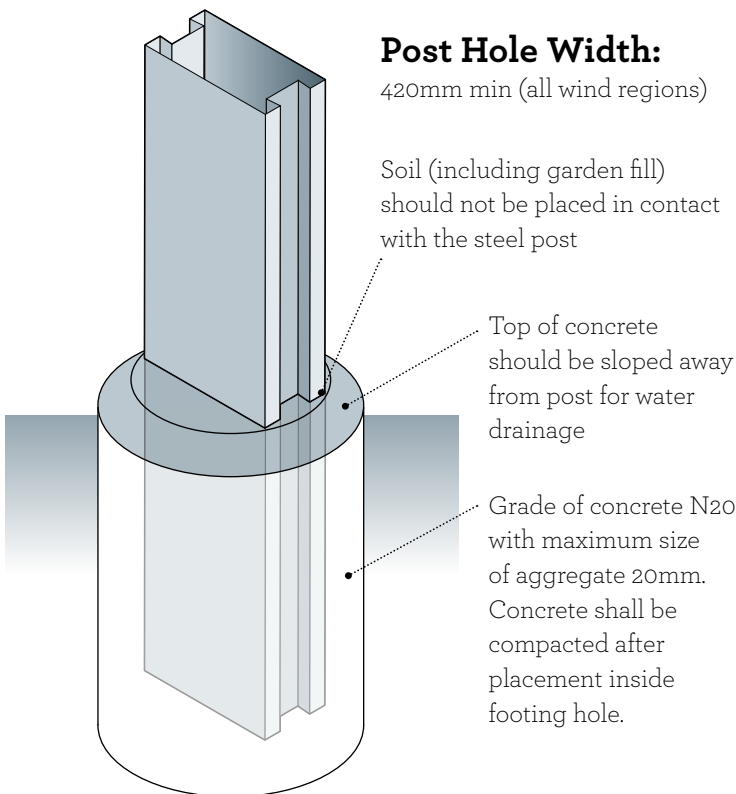
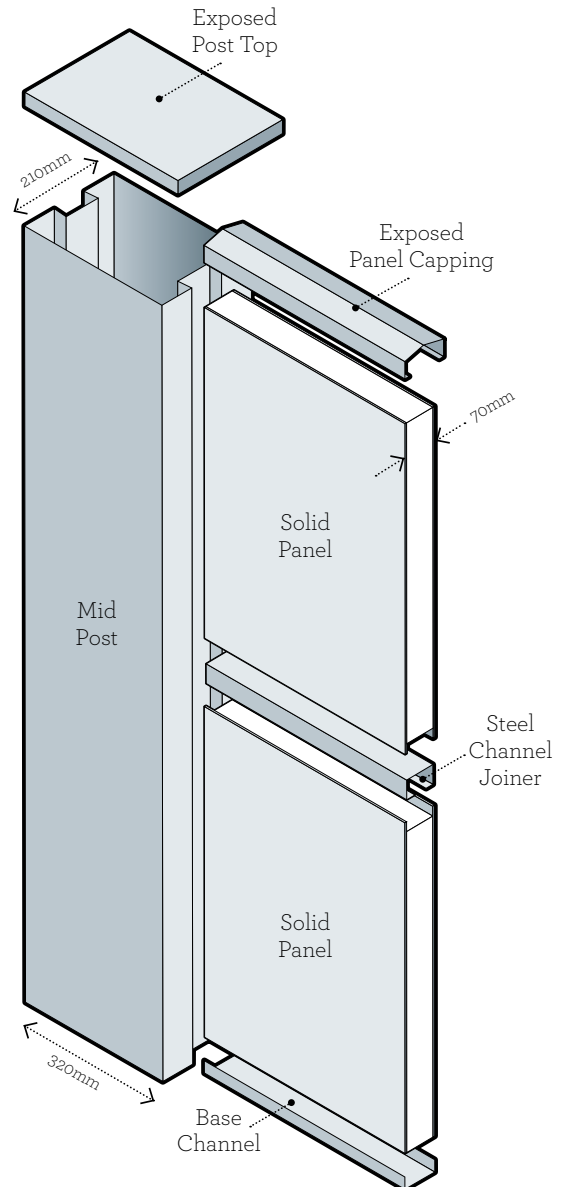
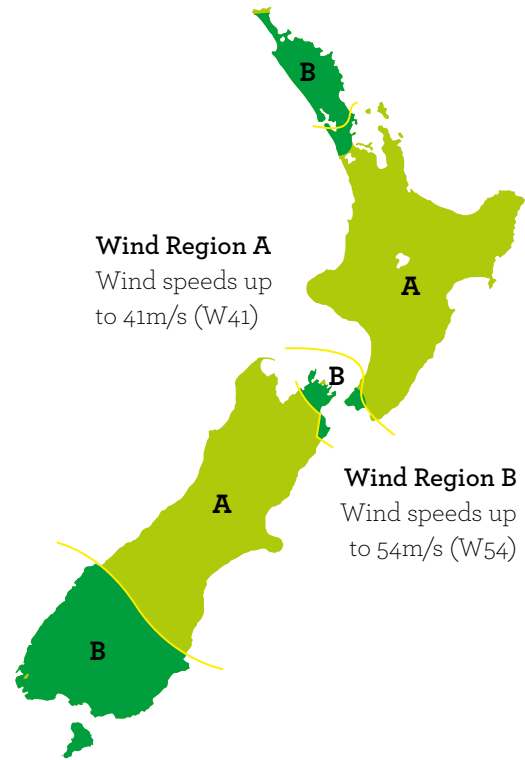

ESTATE

PRE-PRIMED STEEL COMPONENTS

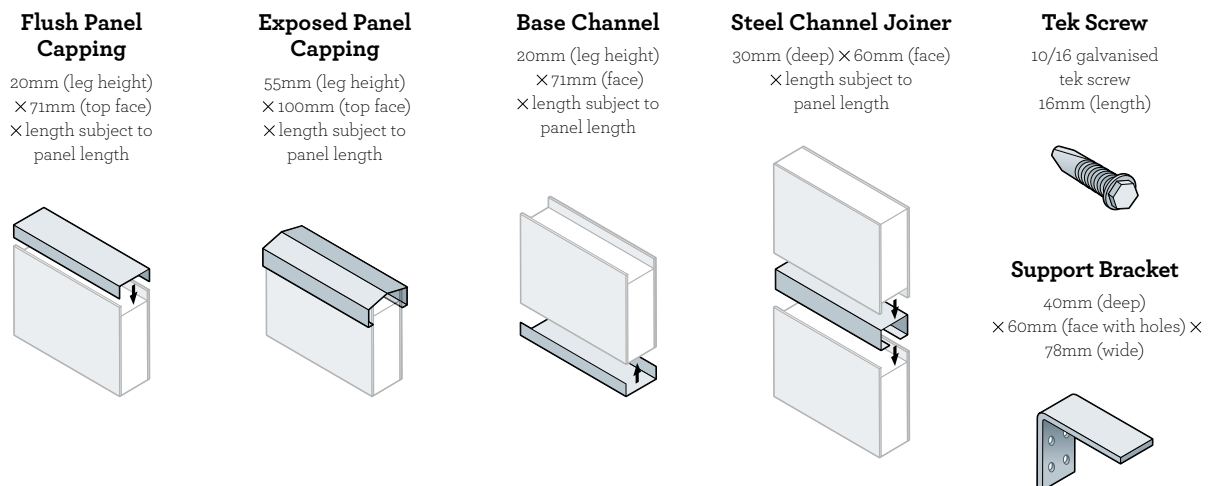
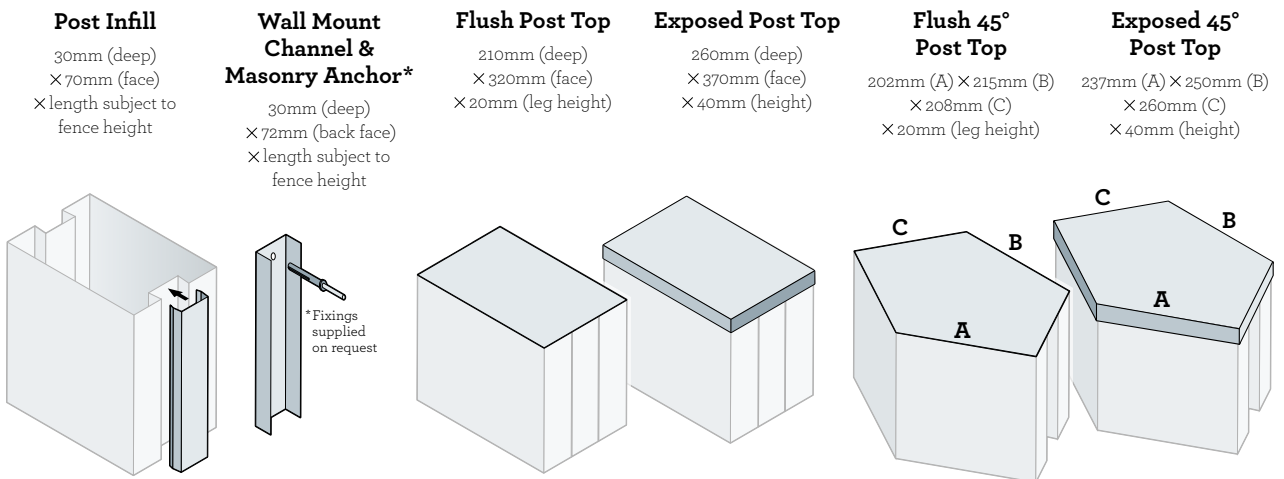
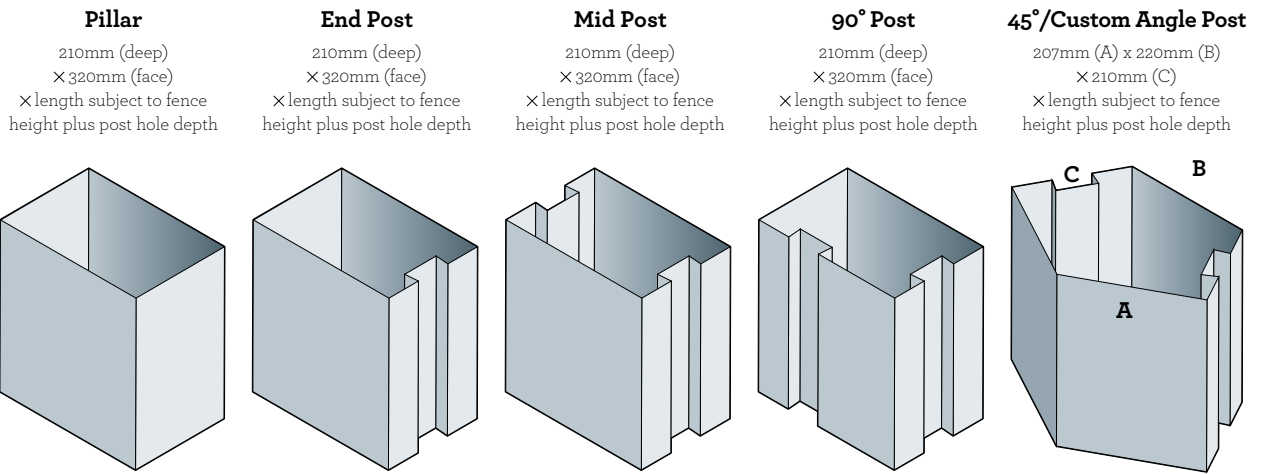

ESTATE INFILL PANELS

Slat, Louvre, Aurora and **Glass Infills** are also available to enhance your fencing. Please refer to the individual infill pages later in this section.

SOLID WALL CAPPING OPTIONS

FULL EXPOSED CAP

Exposed caps for panels and posts, will give your fence a timeless look.

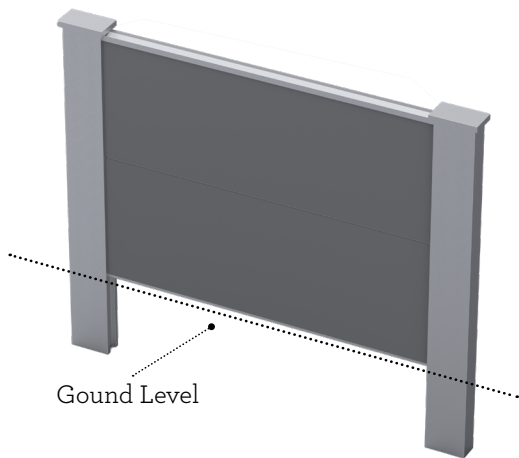

EXPOSED PANEL CAPS

Exposed panels caps with flush post caps, for sleek style.

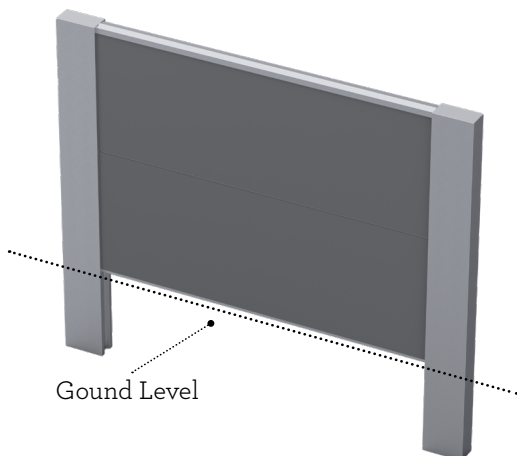

FLUSH CAP

Flush capping for panels and posts, for a minimalist modern look.

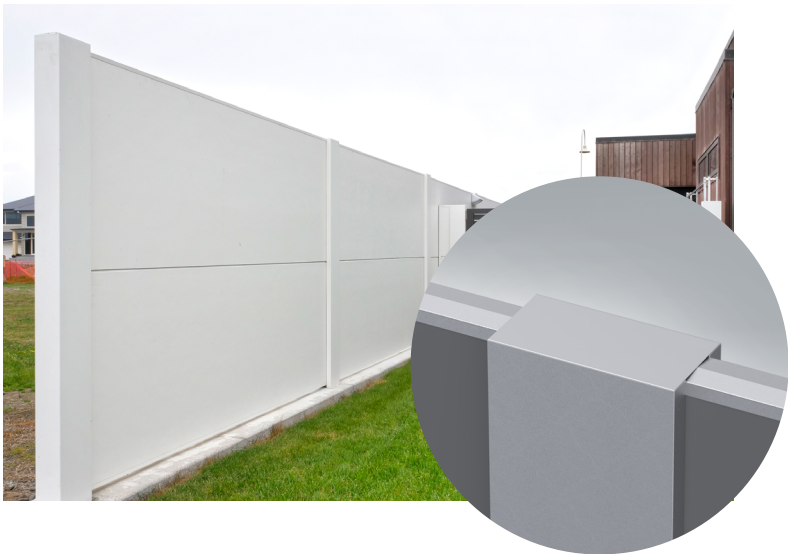
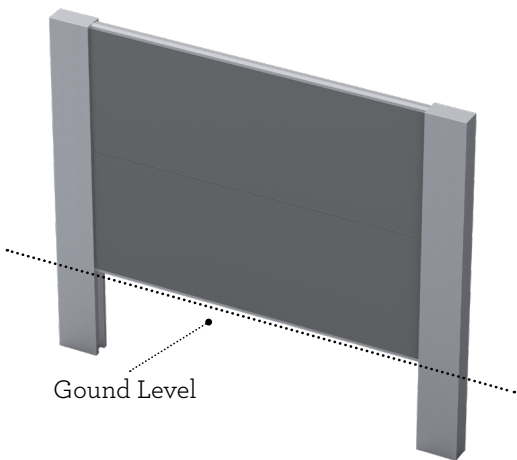

EXPOSED POST CAPS

Exposed posts caps with flush panel caps, for a basic style.

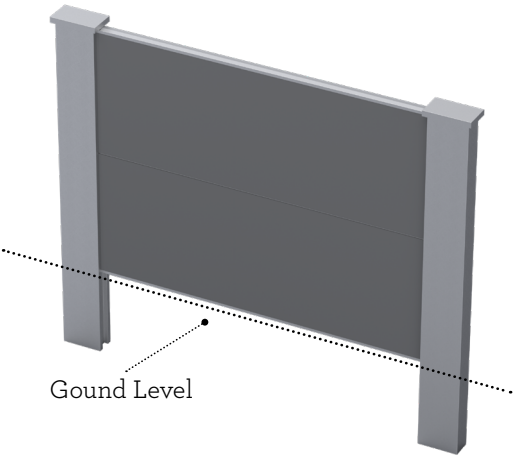

CLASSIC PANELS

SOLID PANELS

Construction:

5mm fibre cement outer skins
40mm expanded polystyrene core

2400mm (length) x 600mm (height) x 50mm (width)

2400mm (length) x 900mm (height) x 50mm (width)

2400mm (length) x 1200mm (height) x 50mm (width)

2700mm (length) x 900mm (height) x 50mm (width)

2700mm (length) x 1200mm (height) x 50mm (width)

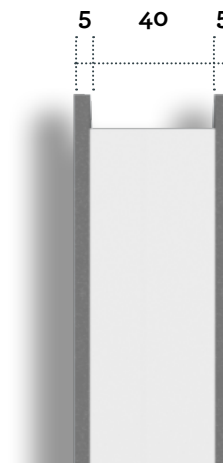
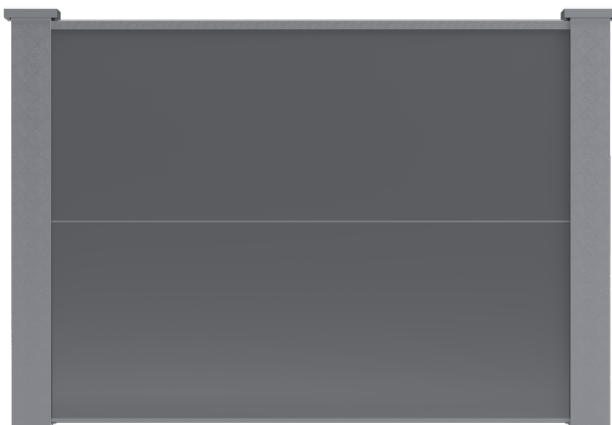

SIGNATURE • ESTATE PANELS

SOLID PANELS

Construction:

5mm fibre cement outer skins
60mm expanded polystyrene core

2400mm (length) x 600mm (height) x 70mm (width)

2400mm (length) x 900mm (height) x 70mm (width)

2400mm (length) x 1200mm (height) x 70mm (width)

2700mm (length) x 900mm (height) x 70mm (width)

2700mm (length) x 1200mm (height) x 70mm (width)

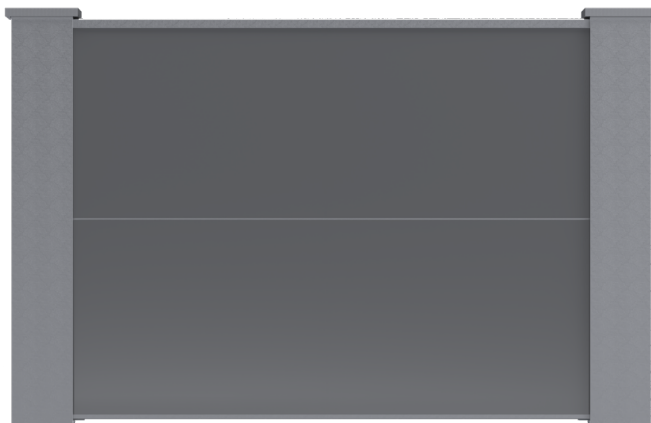

CLASSIC • SIGNATURE • ESTATE INFILL PANELS

HORIZONTAL SLAT INFILL PANELS

Slat Infill Panel Height Options:

300mm 900mm 1500mm

600mm 1200mm 1800mm

Slat Sizes:

2330mm (length) x 60mm (height) x 25mm (width)

2330mm (length) x 85mm (height) x 25mm (width)

2630mm (length) x 60mm (height) x 25mm (width)

2630mm (length) x 85mm (height) x 25mm (width)

Slat Construction:

Powdercoated aluminium

85mm x 25mm

60mm x 25mm

Construction

Aluminium slat channel with cover, powdercoated to same colour as the slats.

Slat Channel: 39mm x 32mm (includes screw cover plate)

Slat channel length will be cut to length required - total height of all slats plus gaps between slats, and gaps top and bottom.



Titania



Gull Grey



Slate Grey



Grey Friars



Ironsand



Flax



Ebony

60mm only available in Ebony

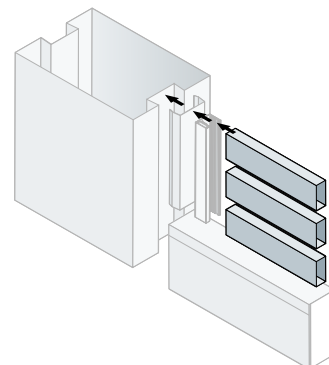
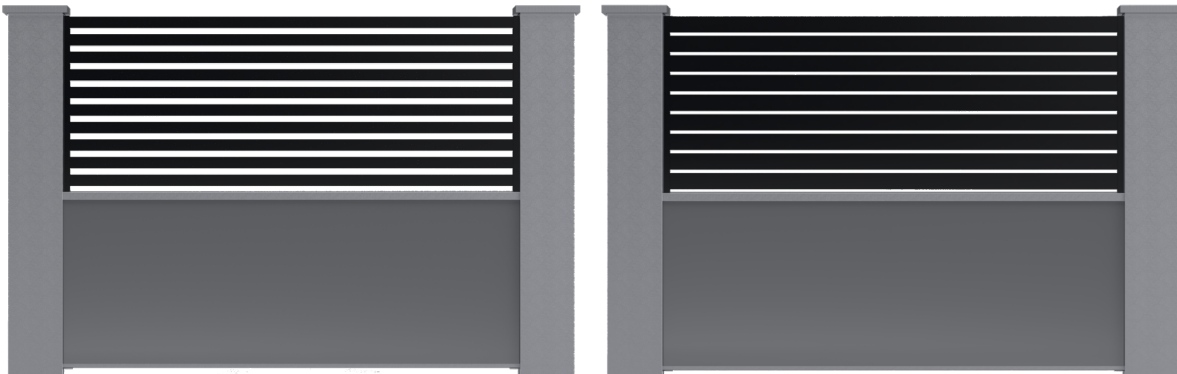

CLASSIC • SIGNATURE • ESTATE INFILL PANELS

VERTICAL SLAT INFILL PANELS

Slat Infill Panel Height Options:

300mm 900mm 1500mm
600mm 1200mm 1800mm

Slat Sizes:

2330mm (length) x 60mm (height) x 25mm (width)
2330mm (length) x 85mm (height) x 25mm (width)
2630mm (length) x 60mm (height) x 25mm (width)
2630mm (length) x 85mm (height) x 25mm (width)

Slat Construction:

Powdercoated aluminium

85mm x 25mm 60mm x 25mm

Construction:

Aluminium slat channel with cover, powdercoated to same colour as the slats.

Slat Channel: 39mm x 32mm (includes screw cover plate)

Vertical Slat channel length will be cut to length required - Horizontal channels will be supplied ready to be trimmed down to the required length onsite.

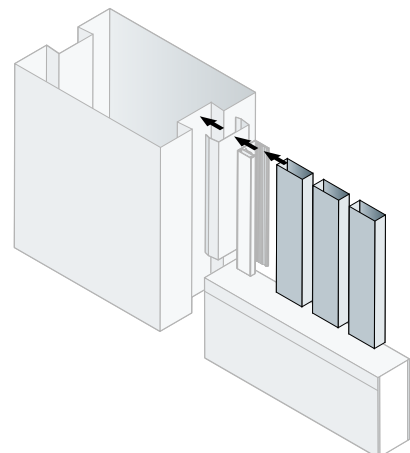
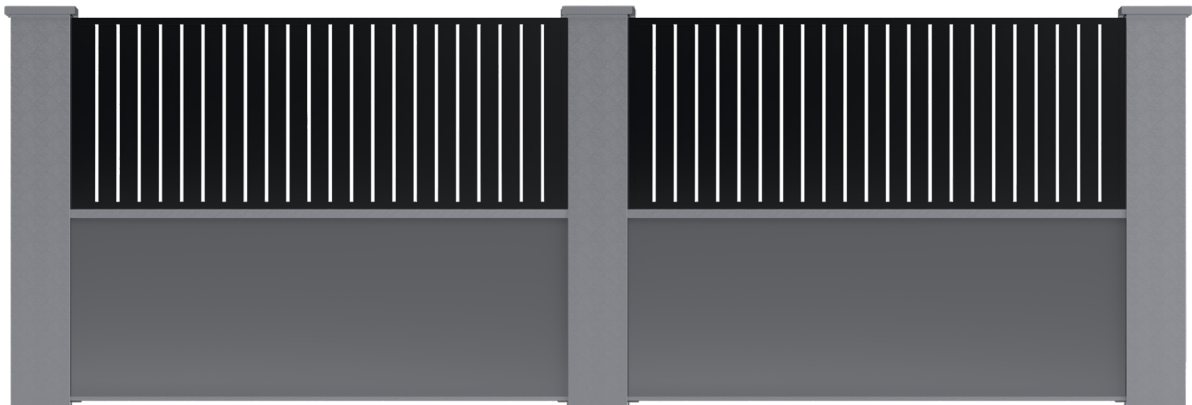

SIGNATURE • ESTATE INFILL PANELS

LOUVRE INFILL PANELS

Louvre Infill Panel Height Options:

350mm (3 louvres) 1200mm (10 louvres)

600mm (5 louvres) 1500mm (13 louvres)

900mm (8 louvres) 1800mm (15 louvres)

Louvre Sizes:

2400mm (length) x 136mm (height) x 32mm (width)
to suit 2400mm panels

2700mm (length) x 136mm (height) x 32mm (width)
to suit 2700mm panels

Construction:

Powdercoated to your colour choice.

Aluminium Louvre 135mm x 30mm inserted into a prepunched steel Channel that accepts the louvre infill.

Louvres may need to be cut shorter onsite to be inserted onto the fixing bar. The finished assembly can then be inserted between the posts.

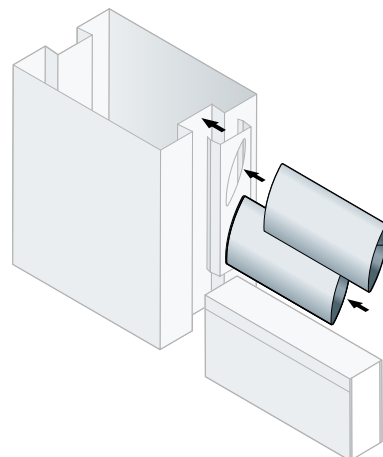

SIGNATURE • ESTATE INFILL PANELS

AURORA INFILL PANELS

Aurora Infill Panel Height Options:

900mm 1500mm

1200mm 1800mm

Aurora Infill Panel Designs:

See the Aurora pages for the range of different panel designs.

Slat Construction:

Powdercoated aluminium

60mm x 25mm

Construction:

Aluminium slat channel with cover, powdercoated to same colour as the slats.

Slat Channel: 60mm x 32mm (includes screw cover plate)

Vertical Slat channel length will be cut to length required - Horizontal channels will be supplied ready to be trimmed down to the required length onsite.

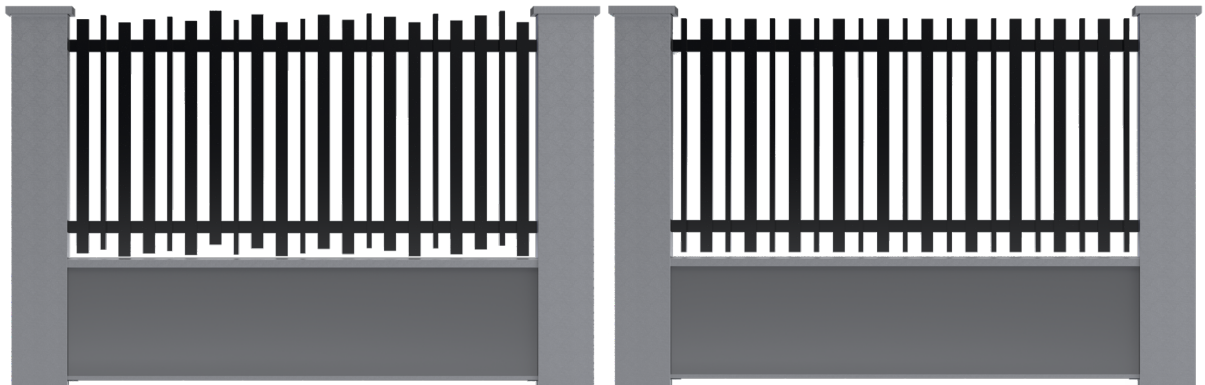

SIGNATURE • ESTATE INFILL PANELS

GLASS INFILL PANELS

For the 70mm rebate in the Signature and Estate posts only

Construction:

12mm toughened safety glass

**2380mm (length) x 1200mm Max. (height)
x 12mm (width)**

Max Glass Panel Size

**2400 Max (length) x 1200mm. (height)
x 12mm (width)**

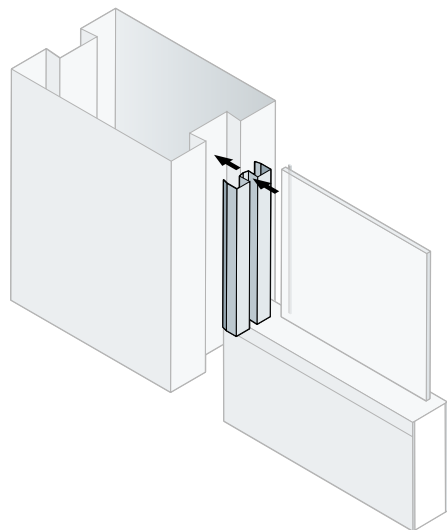
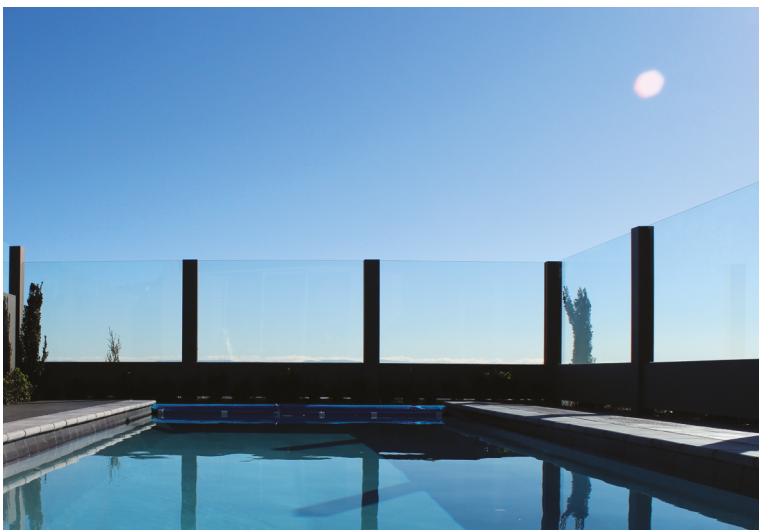
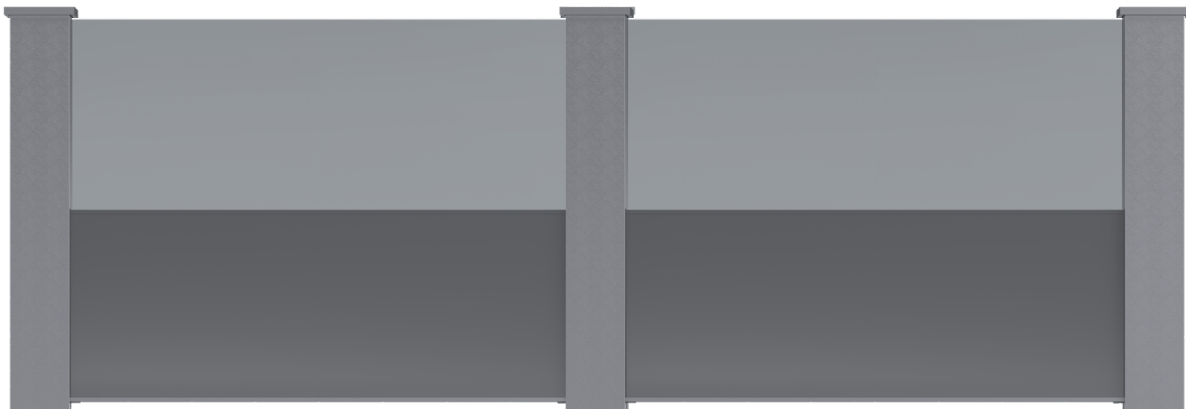

Otaki Oasis

This home has taken full advantage of our product range and has integrated three distinct types of our fencing to delineate various zones within the property. Nestled in the outskirts of Otaki, this customer has used creativity in using our Estate Solid wall fencing as a wind break and privacy screen around the outdoor bath as well as the pool area. The project aims to blend functionality with aesthetic appeal while providing privacy, security, and character to the property.

Project Specifications:

Estate Solid Wall

Full Exposed Capping

Horizontal Slat Infill



River Road Residence

This customer initially contacted us in 2010 with project requirements of boundary fencing along the front of her property and bordering off the pool area for ultimate privacy.

To meet her requirements, we offered a mix of Solid Acoustic wall at 2.1 meters high as well as our Signature Solid Wall at 2.1 meters high. This meant we were able to block out the traffic noise from River road and keep the pool area looking uniform to enhance the landscaping.

After 14 years, our marketing team recently revisited the site, only to find the fence looking near new!

Project Specifications:

Signature Wall

60m x 2.1 high

Acoustic Solid Wall

80m x 2.1m High



Karaka Pines Retirement Village

Karaka Pines Retirement village in Rototuna, Hamilton, asked for an aesthetically pleasing boundary fence with noise reduction and privacy benefits.

Project Specifications:

Estate Wall

314m x 1.8m high

Exposed Capping, Solid/Slat Bays

900mm high with 900mm high of vertical 85mm slats with 33mm gaps

Colour

Painted double concrete, slats powder coated Grey Friars

Client: Karaka Pines Group Limited

Architect: Boffa Miskell

Landscaper: Evergreen Landcare LTD



